

That'll Do Australian Shepherd Club Farm Trial, Stock Trials & Conformation

July 1-3, 2011

(sanctioning pending)

This event will be held in accordance with ASCA rules and regulations: <http://www.asca.org/formsandrulebooks>

No entry shall be accepted from a dog or handler disqualified from the ASCA Conformation program; a dog or handler disqualified from all ASCA programs; or a person not in good standing with ASCA.

All dogs must be able to provide rabies certificate and vaccination record upon request. All dogs must be kept on leash or in crate when not competing. No exceptions. Please pick up after your dogs.

That'll Do Australian Shepherd Club will not be responsible for personal injury or damage / loss of property.

WARNING

UNDER IOWA LAW, A DOMESTICATED ANIMAL PROFESSIONAL IS NOT LIABLE FOR DAMAGES SUFFERED BY, AN INJURY TO, OR THE DEATH OF A PARTICIPANT RESULTING FROM THE INHERENT RISKS OF DOMESTICATED ANIMAL ACTIVITIES, PURSUANT TO IOWA CODE CHAPTER 673. YOU ARE ASSUMING INHERENT RISKS OF PARTICIPATING IN THIS DOMESTICATED ANIMAL ACTIVITY.

LOCATION: Bergert's Farm, 3160 220th St, Williams, IA 50271

Show/trial grounds will open at 5:30am. All events will be held outdoors. Stock events held on dirt surface, Conformation held on grass. Bring your E-Z ups and chairs!
No electricity will be available for grooming on site.

DIRECTIONS: Highway 35 North or South to exit 144. One mile East of the Boondocks truck stop. Follow the road straight do not take the curve. White house on the South side of the road.

FOOD: Food will be available on site Saturday and Sunday only. Provided by the Central Iowa Collie Club. TDASC will provide dinner on Saturday evening. \$10 for adults. \$5 for kids. Supper sign-up sheet at end of flyer.

CAMPING: Boondocks USA Truck Stop (10-12 spots) No reservations I-35 US20, Williams, IA (515) 854-2411

HOTELS:

(1 mile from trial/show location)

Best Western Norseman Inn

3086 220th Street, Williams, IA - (515) 854-2281

Iowa Falls (approx. 20 min from trial/show location)	Webster City (approx. 20 min from trial/show location)
AmericInn 810 South Oak, Iowa Falls, IA - (800) 634-3444	AmericInn 411 Closz Drive, Webster City, IA - (800) 634-3444
Super 8 839 South Oak Street, Iowa Falls, IA - (641) 648-4618	Executive Inn 1700 Superior Street, Webster City, IA - (800) 322-3631
Scenic Inn 11237 Highway 65, Iowa Falls, IA - (641) 648-2553	Super 8 305 Closz Drive, Webster City, IA - (515) 832-2000

EMERGENCY VETERINARIAN CARE:

Webster City Veterinary Clinic 113 East 2nd Street, Webster City, IA (515) 832-1700	Midwest Animal Health Center 607 South Oak Street, Iowa Falls, IA (641) 648-4036
--	---

STOCK

Farm Trial 7/1/2011 (diagram attached)
AM & PM Stock Trial 7/2/2011 (course A)
AM & PM Stock Trial 7/3/2011 (course A)

Course Director	James Bergert 3160 220 th St. Williams, IA 50271
Show Coordinator	Todd Dirksen 1861 Lark Ave., Hampton, IA 50441
Location	3160 220 th St, Williams IA 50271
Judges	Tanya Wheeler (Farm Trial), Rachel Vest & Roy Sage
Course Director	James Bergert

NON-ASCA REGISTERED DOGS: May enter the stock trial without a tracking number however only those with a tracking number will be awarded ASCA titles upon completing the title requirements. More information is available on the ASCA website: www.asca.org

STOCK TRIAL CLASSES OFFERED

Working Junior Handler, Open Working Junior, Advanced, Open, Started, Novice, For Exhibition Only.

PRIZES OFFERED

- High Scoring: Ducks, Sheep, Cattle.
- High in Trial: Aussie & Other Breed.
- High Combined WTCH & non-WTCH: Combo of 12 runs over the weekend.
- High Combined WTCH & non-WTCH Other Breed: Combo of 12 runs over the weekend.
- Most Promising Started Aussie & Other Breed.
- Ribbons for class placements first through fourth place.

TRIAL INFORMATION: Draw for run order will be after trial registration closes. Bitches in heat will run in order of draw, but must be crated and exercised away from the competition. Overflow judges may be hired and the limit of runs per day as well as judging assignments may change. All breeds recognized by ASCA as herding breeds are eligible to enter the trial. Owners of dogs will be responsible for all injuries to livestock; replacement cost will be determined at fair market value.

12 maximum cattle runs per trial - 13 minimum duck runs per trial - 25 minimum sheep runs per trial

Based on entries, the above listed limits may change and judging assignments may change. Any changes will be posted at the Trial Registration Desk in advance of the Trial starting.

Stock Entry Fees

A \$30 discount will be given if all classes of stock in trials (including farm trial) are entered

	PRE-ENTRY	DAY OF ENTRY
Farm Trial	\$50	\$55
Juniors	\$8	\$10
Ducks	\$25	\$30
Sheep	\$30	\$35
Cattle	\$40	\$45

Send Pre-entries to:

James Bergert
3160 220th St.
Williams, IA 50271

Make checks payable to TDASC

PRE-ENTRIES MUST BE POSTMARKED NO EARLIER THAN MONDAY, MAY 23, 2011 AND NO LATER THAN FRIDAY, JUNE 24, 2011

Sorry, no phone or email entries.

ASCA Entry Forms with text entry can be found at: <http://www.asca.org/Portals/0/stockentwfill.pdf>

All entries must be paid in full at the close of registration prior to each event.

Telephone, facsimile or incomplete entries will not be accepted. All entries must be on the official ASCA entry form with proper fees included. Exhibitors are responsible for the accuracy of the entry and the class entered.

Withdrawals of entries will be accepted until the Pre-entry closing. Thereafter, no refunds will be made.

FARM TRIAL (12 runs)

Open Level

1. Move 10 head from small round pen to large round pen (25 points)
2. Sort 5 unmarked head into take pen (25 points)
3. Take those 5 head to the trailer and load them on trailer (15 points)
4. Go back to round pen and take 5 marked head through take pen to feed pan at far end of arena and hold stock at pan. Gather will be 150 feet. (15 points)
5. You and dog go to the handler's post, leave dog at the post. Handler can go half way to stock, send dog to gather stock and take them to chute pen and put stock in pen (25 points)
6. Put stock in chute to vaccinate them, then remove them from chute and pen and put them back in take pen (25 points)

Advanced Level

Take stock out of barn and move to large round pen, then sort. Advanced dogs and handlers both stay at handler's post to gather stock to chute pen. 20 minutes per run.

Tie Breakers

1. Trailer Score
2. Gather

20 minute time limit

5 minute warning will be given at 15 minute mark.

(diagram on following page)

Farm Trial

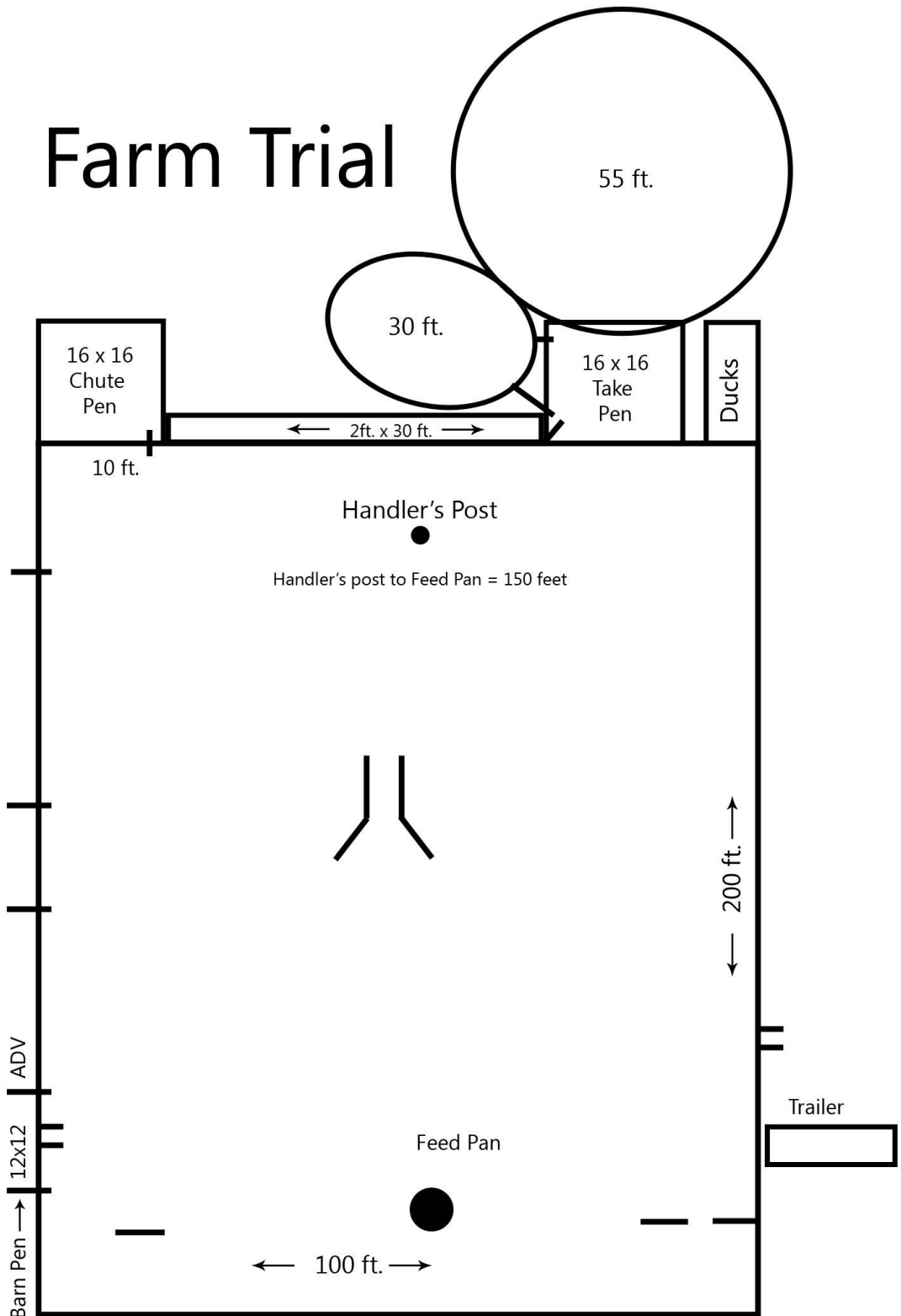

CONFORMATION

One show will be held on 7/2/2011 & two shows will be held on 7/3/2011

Show Secretary	Lorie Halsne, 3398 130th Street, Thornton, IA 50479
Show Chair	Todd Dirksen 1861 Lark Ave., Hampton, IA 50441
Location	3160 220 th St, Williams IA 50271
Judges	Karen MacDonald (Sat. p.m.), Linda Friedow (Sun. a.m.), Rory Friedow (Sun. p.m.)

Classes offered and show order

Puppies	2-4 Month & 4-6 Month, divided by sex
Junior Showmanship	<u>Non-Regular</u> : Pee Wee & Sub Junior <u>Regular</u> : Novice & Open 8-12, Novice & Open 13-17
Conformation	<u>Altered & Regular</u> : 6-9, 9-12, 12-18, Novice, Am. Bred, BBX, Open Blue Merle, Open Red Merle, Open Black & Open Red (All Classes divided by sex). Best of Breed.

PRIZES OFFERED

1st through 4th place Junior Showmanship: Ribbons.

Best Junior Handler & Reserve Junior Handler: Rosettes.

1st through 4th place class: Ribbons.

Winners Dog, Reserve Winners Dog, Winners Bitch, Reserve Winners Bitch: Rosettes. (Regular & Altered)

Best of Breed, Best of Opposite Sex & Best of Winners: Rosettes. (Regular & Altered)

Conformation Entry Fees

	PRE ENTRY	DAY OF ENTRY
Junior Showmanship	\$3	\$5
Non-Regular	\$8	\$10
Regular and Altered	\$15	\$18

Send Pre-entries to:

Lorie Halsne
3398 130th Street.
Thornton, IA 50271

Make checks payable to TDASC

ENTRIES OPEN MONDAY MAY 23, 2011

PRE-ENTRIES MUST BE POSTMARKED BY FRIDAY JUNE 24, 2011

ASCA Entry Forms with text entry can be found at:

<http://www.asca.org/Portals/812b34ca-1ab9-41bb-9dc9-d7b90411dbdc/showentrywtx.pdf>

All entries must be paid in full at the close of registration prior to each event.

Telephone, facsimile or incomplete entries will not be accepted. All entries must be on the official ASCA entry form with proper fees included. Exhibitors are responsible for the accuracy of the entry and the class entered.

SCHEDULE OF EVENTS & JUDGING ASSIGNMENTS

Friday, July 1, 2011

<i>Farm Trial</i> <i>(limited to 15 runs) Cross bred hair and wool sheep</i>	
Judge: Tanya Wheeler	
7:00am	Day of Entries taken & check-in
7:30am	Entries Close / Handler's Meeting
8:00am	Trial Begins

Saturday, July 2, 2011

<i>Stock AM Trial</i>	
Judges: Rachel Vest (cattle & ducks) Roy Sage (sheep)	
7:00am	Day of Entries taken & check-in
7:30am	Entries Close / Handler's Meeting
8:00am	Trial Begins

<i>Conformation</i>	
Show #1 ASCA Breeder Judge: Karen MacDonald	
12:00pm	Day of Entries taken & check-in
12:30pm	Entries Close
1:00pm	Judging Begins

<i>Stock PM Trial</i>	
Judges: Roy Sage (cattle & ducks) Rachel Vest (sheep)	
PM Trial will follow AM Trial	

Sunday, July 3, 2010

<i>Stock</i>	
Judges: Rachel Vest (cattle & ducks) Roy Sage (sheep)	
7:00am	Day of Entries taken & check-in
7:30am	Entries Close / Handler's Meeting
8:00am	Trial Begins

<i>Conformation</i>	
Show #2 AKC Judge: Linda Friedow	
8:00am	Day of Entries taken & check-in
8:30am	Entries Close
9:00am	Judging Begins

<i>Stock PM Trial</i>	
Judges: Roy Sage (cattle & ducks) Rachel Vest (sheep)	
PM Trial will follow AM Trial	

Show #3	
AKC Judge: Rory Friedow <i>*judging starts at 1pm or no earlier than 30 minutes after a.m. Show</i>	
12:00pm*	Day of Entries taken & check-in
12:30pm	Entries Close
1:00pm	Judging Begins

RAFFLE

We will be holding a raffle to raise funds for That'll Do Australian Shepherd Club.

Drawing will take place on Sunday
between the a.m. and p.m. conformation shows.

***** Donations of raffle items will be accepted through Sunday morning *** Anything you can bring is appreciated!**

SPONSORSHIP

If you would like to send money to sponsor trophies, your name will appear with the award and you can dedicate it however you would like.

Please send sponsorships along with class and credit information to:

JoAnna Rizzo-Bergert
3160 220th St
Williams IA 50271

SUPPER

Adults: \$10 Kids: \$5

If you are interested in sitting down with us for supper on Saturday after we are through with the events of the day, please fill out the form below and send with payment (please make checks payable to TDASC) to:

JoAnna Rizzo-Bergert
3160 220th St
Williams IA 50271

Please be sure to send with pre-entries **POSTMARKED BY FRIDAY JUNE 24, 2010 so we have an idea of how many we will be preparing food for.**

SUPPER

Name: _____

Address: _____

Phone: _____

Number of Adults: _____ Number of Kids: _____